

EXHAUST FAN INFORMATION											
FAN UNIT NO.	FAN UNIT MODEL #	MODEL	TAG	CFM	S.P.	RPM	H.P.	Ø	VOLT	FLA	WEIGHT (LBS.)
1	DU7SHFA	DU7SHFA		1183	0.750	1022	0.750	1	115	13.0	75.73
3	DU3OHFA	DU3OHFA		715	0.500	1314	0.250	1	115	4.0	52.56

**HEATER/MUA FAN INFORMATION**

FAN UNIT NO.	FAN UNIT MODEL #	BLOWER	HOUSING	TAG	CFM	S.P.	RPM	H.P.	Ø	VOLT	FLA	WEIGHT (LBS.)
2	NSAU-G10	G10	NSAU.1		946	0.500	702	0.333	1	115	7.0	184.00

**CURB ASSEMBLIES**

NO.	ON FAN	ITEM	SIZE
1	# 1	Curb	23,000" W x 23,000" L x 14,000" H
2	# 2	Curb	23,000" W x 23,000" L x 14,000" H
3	# 3	Curb	19,500" W x 19,500" L x 14,000" H

FAN #2 NSAU-G10 - SUPPLY FAN  
 1. SUPPLY HOOD WITH 12" BLOWER IN SIZE # HOUSING  
 2. SUPPLY HOOD WITH 12" BLOWER IN SIZE # HOUSING  
 3. DOWN DISCHARGE - AIR FLOW RIGHT -> LEFT

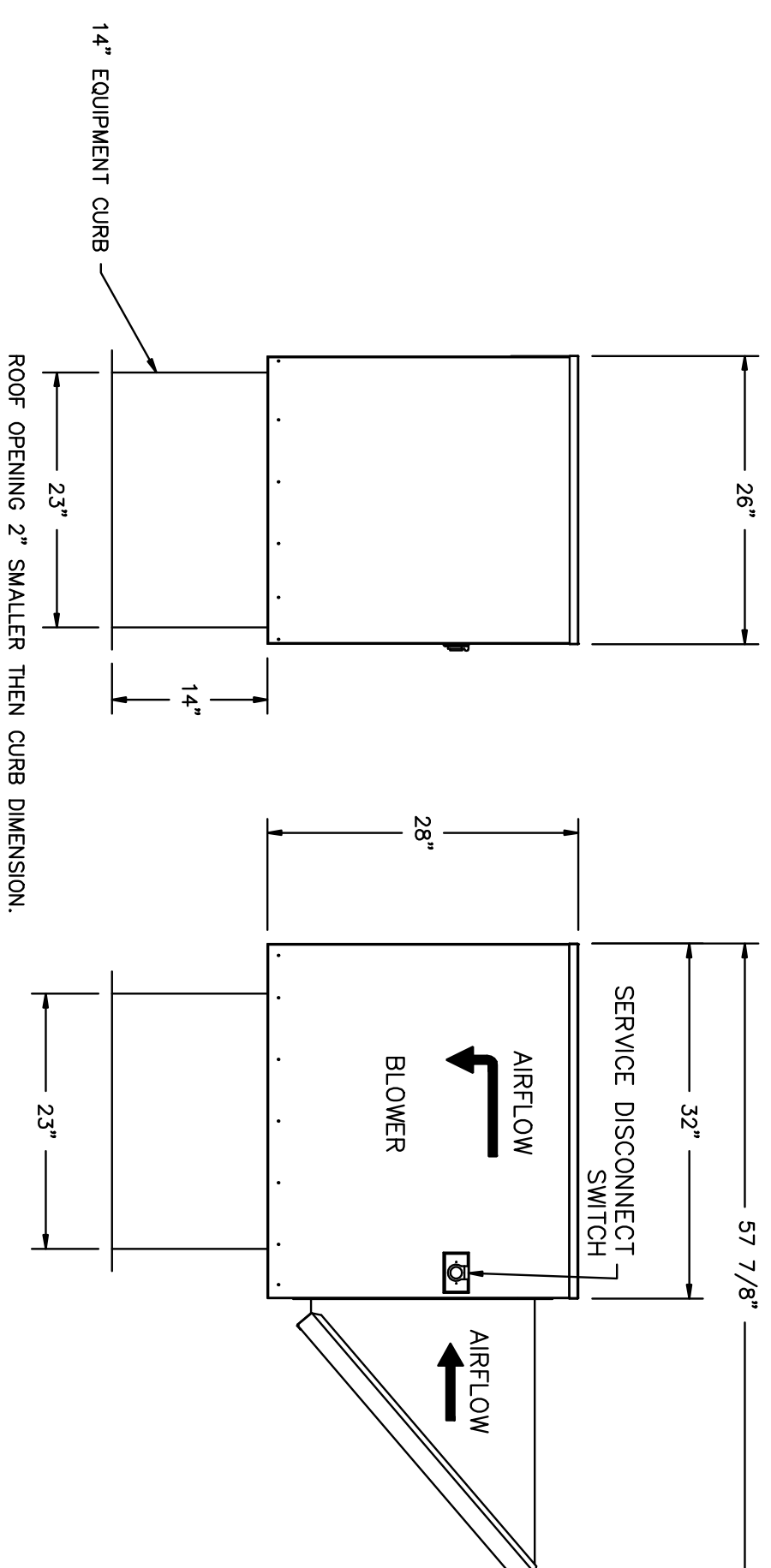
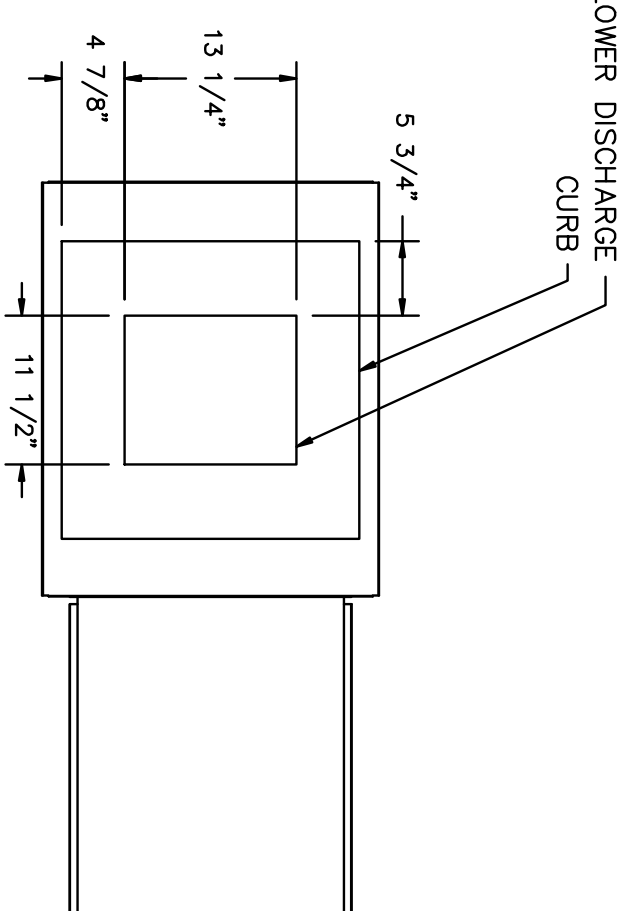
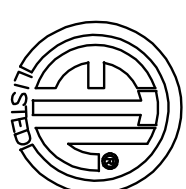

ROOF OPENING 2" SMALLER THEN CURB DIMENSION.

FAN #1 DU7SHFA - EXHAUST FAN

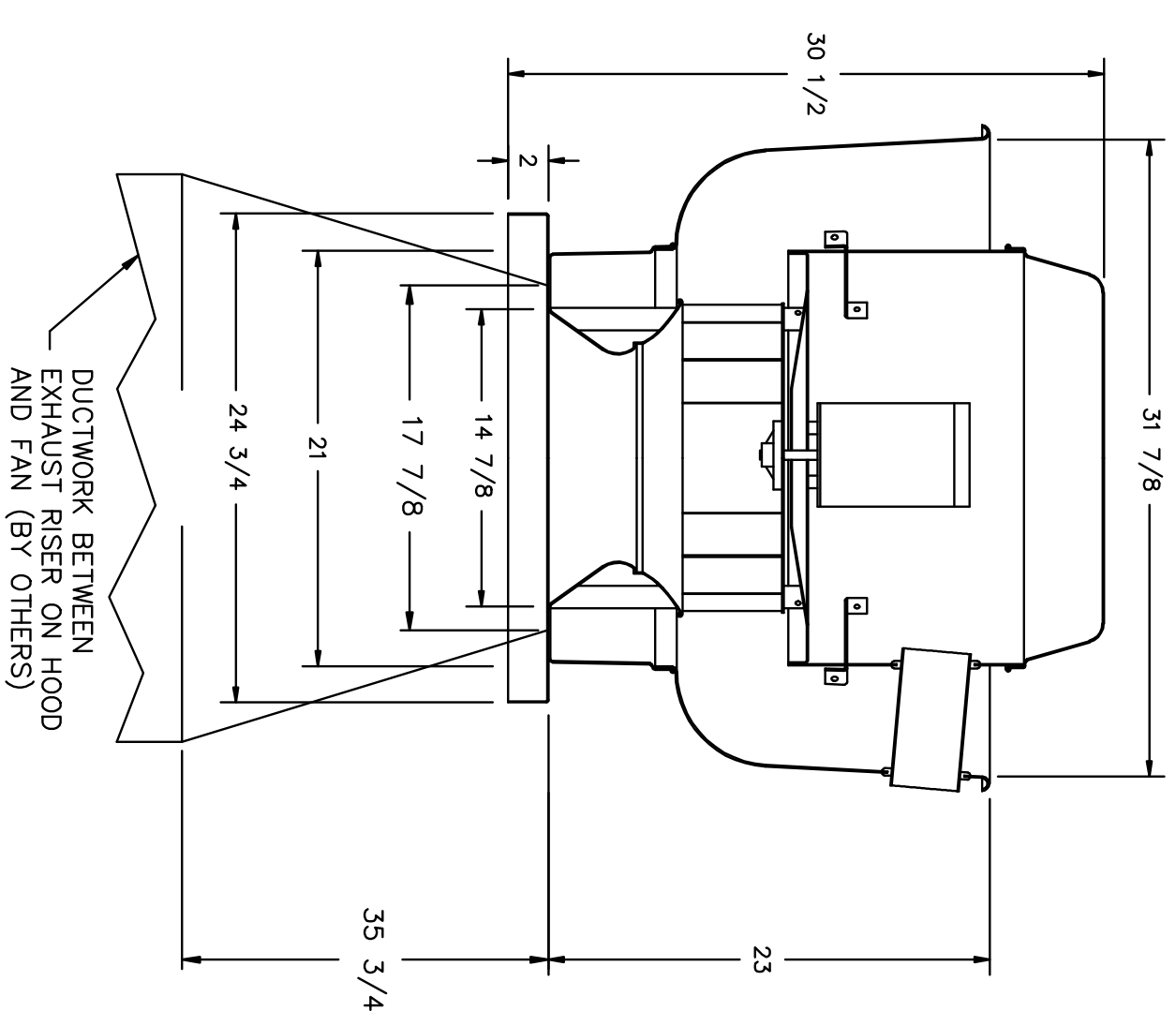

**FEATURES:**

- ROOF MOUNTED FANS
  - RESTAURANT MODEL
  - UL705 AND UL762
  - VARIABLE SPEED CONTROL
  - INTERNAL WIRING
  - WEATHERPROOF DISCONNECT
  - THERMAL OVERLOAD PROTECTION (SINGLE PHASE)
  - HIGH HEAT OPERATION 300°F (149°C)
  - GREASE CLASSIFICATION TESTING
- NORMAL TEMPERATURE TEST**  
 EXHAUST FAN MUST OPERATE CONTINUOUSLY WHILE EXHAUSTING AIR AT 300°F (149°C) UNTIL THERMAL EQUILIBRIUM IS REACHED WITHOUT ANY DETERIORATING EFFECTS TO THE FAN WHICH WOULD CAUSE UNSAFE OPERATION.
- ABNORMAL FLARE-UP TEST**  
 EXHAUST FAN MUST OPERATE CONTINUOUSLY WHILE EXHAUSTING BURNING GREASE VAPORS AT 600°F (316°C) FOR A PERIOD OF 15 MINUTES WITHOUT THE FAN BECOMING DAMAGED TO ANY EXTENT THAT COULD CAUSE AN UNSAFE CONDITION.

\*THE INTAKE OF SUPPLY FAN HAS TO BE 10 FEET AWAY FROM EITHER EXHAUST FAN.

FAN #3 DU3OHFA - EXHAUST FAN

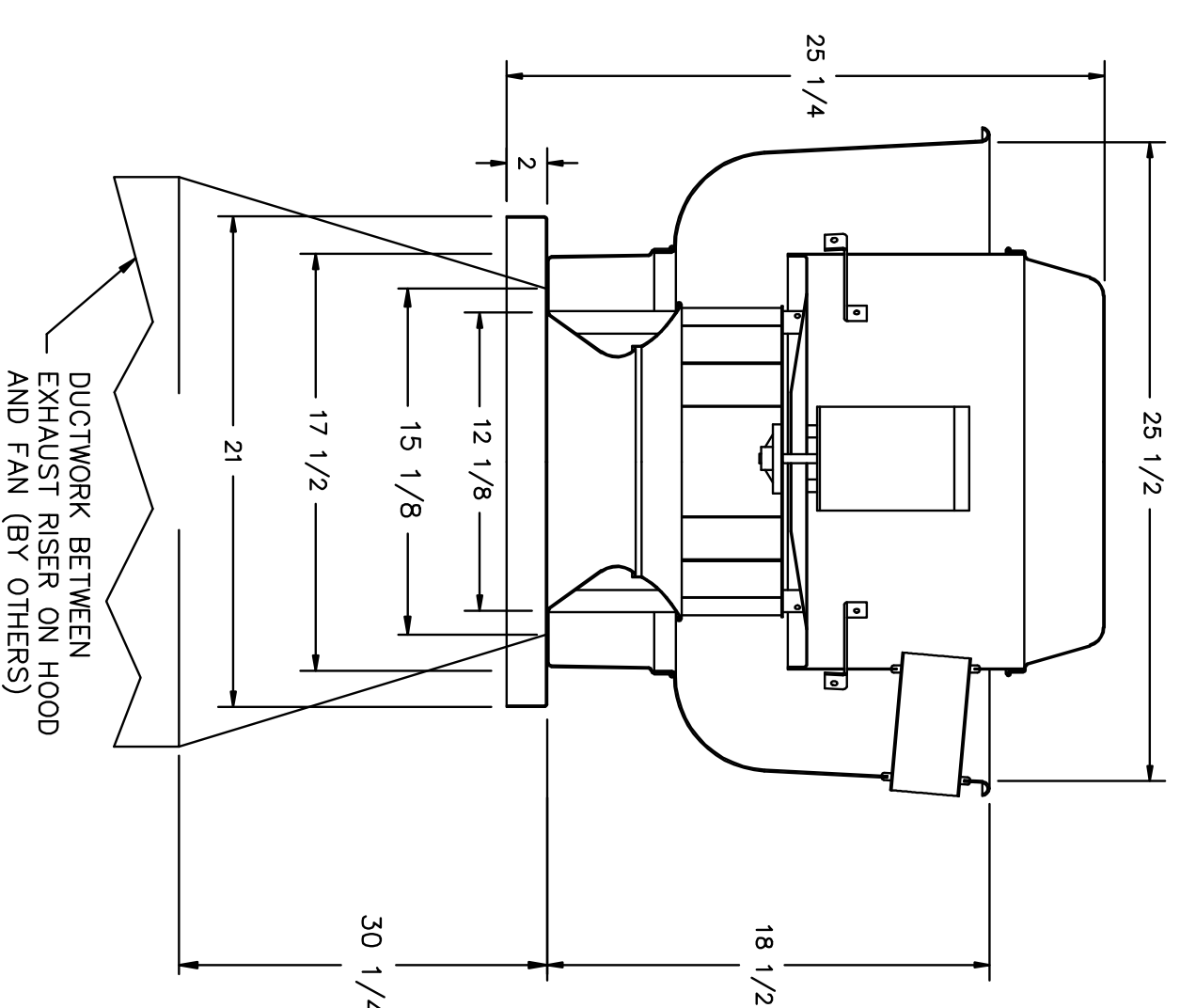

**FEATURES:**

- ROOF MOUNTED FANS
  - RESTAURANT MODEL
  - UL705 AND UL762
  - VARIABLE SPEED CONTROL
  - INTERNAL WIRING
  - WEATHERPROOF DISCONNECT
  - THERMAL OVERLOAD PROTECTION (SINGLE PHASE)
  - HIGH HEAT OPERATION 300°F (149°C)
  - GREASE CLASSIFICATION TESTING
- NORMAL TEMPERATURE TEST**  
 EXHAUST FAN MUST OPERATE CONTINUOUSLY WHILE EXHAUSTING AIR AT 300°F (149°C) UNTIL THERMAL EQUILIBRIUM IS REACHED WITHOUT ANY DETERIORATING EFFECTS TO THE FAN WHICH WOULD CAUSE UNSAFE OPERATION.
- ABNORMAL FLARE-UP TEST**  
 EXHAUST FAN MUST OPERATE CONTINUOUSLY WHILE EXHAUSTING BURNING GREASE VAPORS AT 600°F (316°C) FOR A PERIOD OF 15 MINUTES WITHOUT THE FAN BECOMING DAMAGED TO ANY EXTENT THAT COULD CAUSE AN UNSAFE CONDITION.

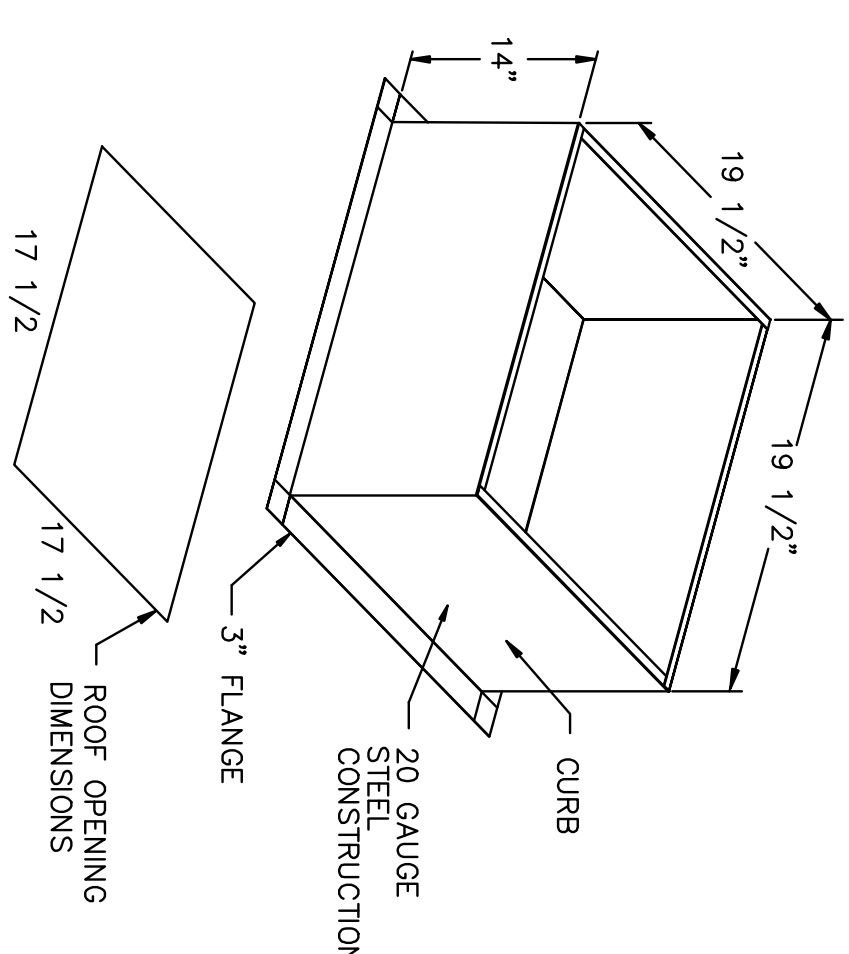
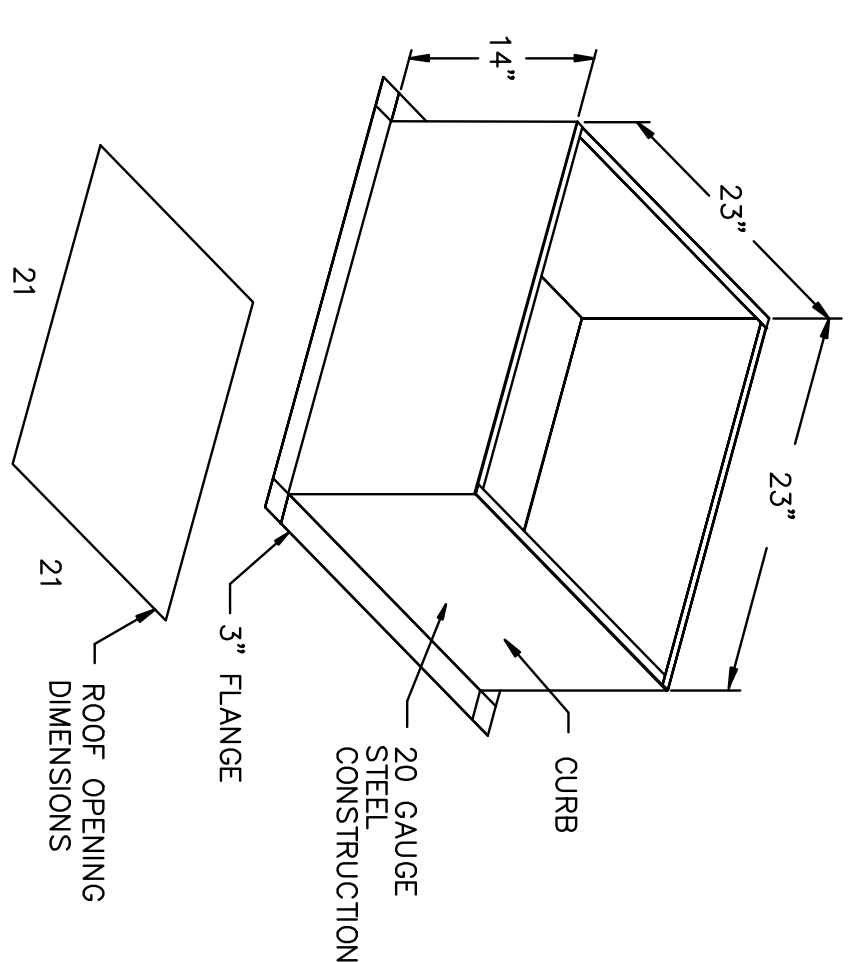

**TRIMCOS DESIGN & ENG.**

11222 RICHMOND AVE.  
 SUITE# 225 HOUSTON TX, 77082  
 (281) 558-8696  
 F-3926

SCHLOTZSKY'S VICTORY LAKES TOWN CENTER  
 TRACK 7A, NEC INTERSTATE HWY 45 & F.M.646  
 LEAGUE CITY TEXAS 77000

**ARCH**  
 Woo Associates, LL  
 ARCHITECTS - PLANNERS  
 13734 Branford Green Dr.  
 Houston, TX. 77083  
 (832) 228-8128

Date 07-14-2010  
 Scale AS SHOWN  
 Drawn by  
 Job #:  
 SHEET NO.

M-04

Rev.	By	Date