

Rev.	By	Date

**SCHLOTZSKY'S**  
**@ VICTORY LAKETOWN CENTER**  
**TRACT 7A NEC INTERSTATE HWY 45 & F.M.646**  
**LEAGUE CITY, TEXAS 77573**

**ARCH**  
Woo Associates, LLC.  
ARCHITECTS - PLANNERS  
13734 Brimford Green Dr.  
Houston, TX 77083  
(281) 530-3192

Date	05-26-2010
Scale	AS SHOWN
Drawn by	KW
Job#:	VICTORY LAKE

**AL1.0**

**LANDSCAPE NOTES**

- LANDSCAPING MAY INCLUDE TREES, PARKING LOT TREES, SHRUBS AND SIDE WALKS, GROUND COVER AND SHADE TREES AND OTHER MATERIAL USED FOR ENHANCING THE EXTERIOR APPEARANCE OF DEVELOPED PARKING AREA.
- NATIVE AND WILDLIFE BENEFICIAL SPECIES PREFERRED. ALL PLANT MATERIALS SHALL SUITABLE FOR LEAGUE CITY SOILS AND CLIMATIC CONDITIONS. THE PLANT'S SLOPE EROSION, SHALL MEET THE FOLLOWING REQUIREMENTS.
- UNIFORM DISTRIBUTION PLANT MATERIAL SHOULD BE DISTRIBUTED SO AS TO PROVIDE A RELATIVE UNIFORM AND SOME VISIBILITY INTO THE DEVELOPMENT IS DESIRED. THE PLANT MATERIAL MAY BE ARRANGED TO PROVIDE NEW CORRIDOR.
- GROUND COVER, GROUND COVER MUST BE APPROPRIATE TO THE SURFACE CONDITIONS ON THE AREA. GRASS IS THE DEFAULT LANDSCAPING MATERIAL.
- GC SHALL HIRE LOCAL LANDSCAPER TO PURSUE CITY'S LANDSCAPE ORDINANCE.

**TREE LEGEND**

- LARGE TREE: DECIDUOUS AND BROADLEAF EVERGREENS  
CYPRESS, LINDSEY, GUM, SOUTHERN PINE, 10 FEET HIGH AND 1.5 INCH CALIPER AT TIME OF PLANTING.
- BALDCYPRESS  
ELM  
LIMBOPY  
MANSOULA  
MAPLE  
OAK  
PEZOM  
PEZAN BIRCH  
SYCAMORE  
TEXAS PERSIMMON

- SMALL TREE: CAPABLE OF GROWING BETWEEN 10 AND 15 FEET IN HEIGHT AT MATURITY  
MIN. TRUCK HEIGHT OF 6 FEET AND MIN. OF A 2 INCH SINGLE TRUNK CALIPER MEASUREMENT OR 1.5 INCH AVERAGE TRUCK CALIPER MEASUREMENT FOR MULTIPLE TRUNK TREES WHEN PLANTED MEASURED 4 FEET ABOVE GRADE. THIS SIZE CHINESE PISTACHE REFERRED TO AS 24 INCH BOX.  
MEXICAN PLUM  
PINE  
SAVANNA HOLLY

- SHRUB: SHALL NOT BE LESS THAN 2 FEET HIGH AND 5 GALLONS IN SIZE. GROUND COVER SHALL BE COMPLIED BY LEAGUE CITY REQUIREMENT.

- SHADE TREE: IN THE PARKING LOT AT A RATIO OF 1 TREE FOR EVERY 8 SPACES. TREES SHALL BE DISPERSED THROUGHOUT THE PARKING LOT TO MAXIMIZE THE SHADING OF THE TRUCK SPACES. THE INTERIOR WIDTH LANDSCAPE PLANTER IS 9 FEET.

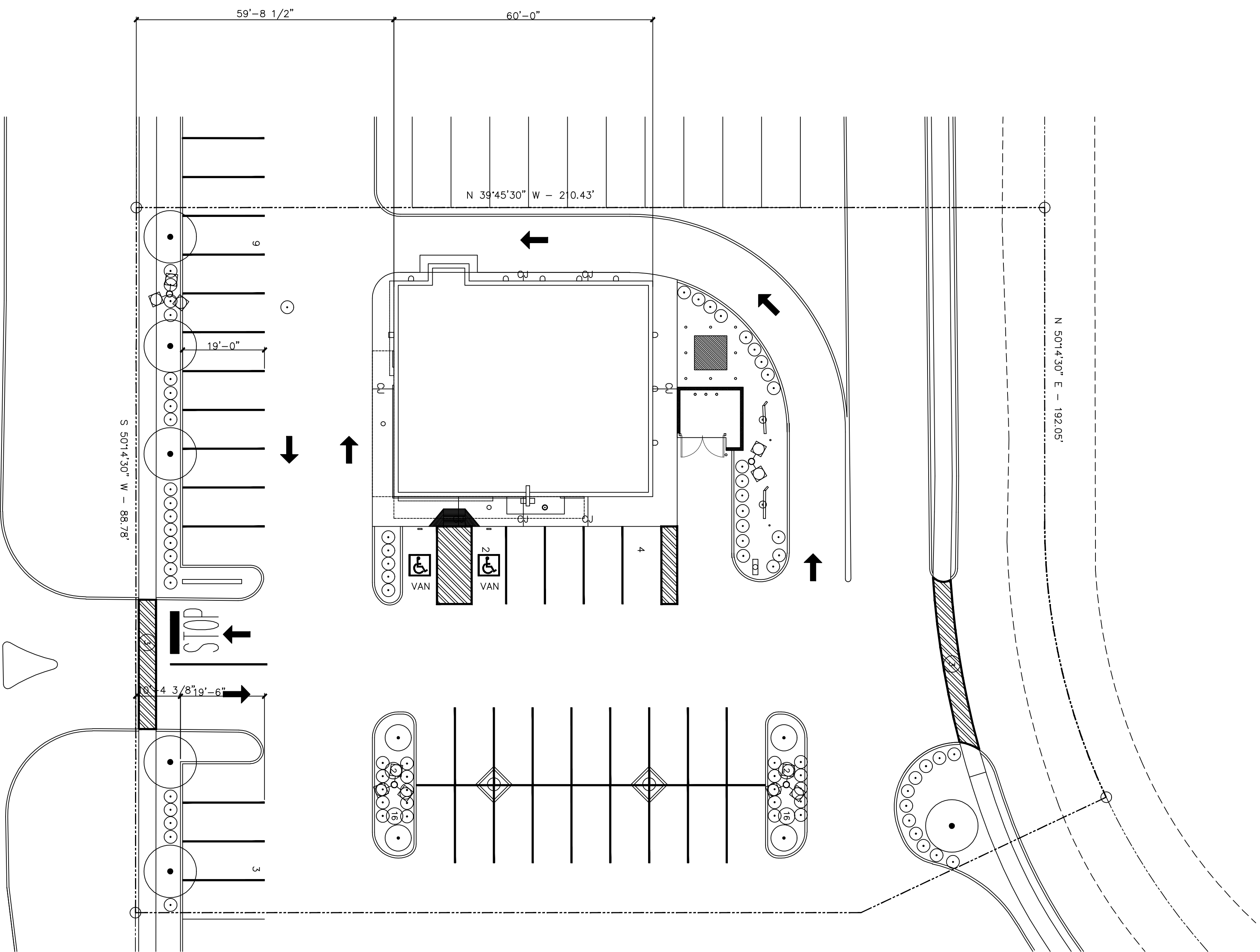

F.M. 646

A. SITE PLAN  
SCALE - 1/8" = 1'-0"  
AREA: 7,000 SQ.FT.